

Suriname

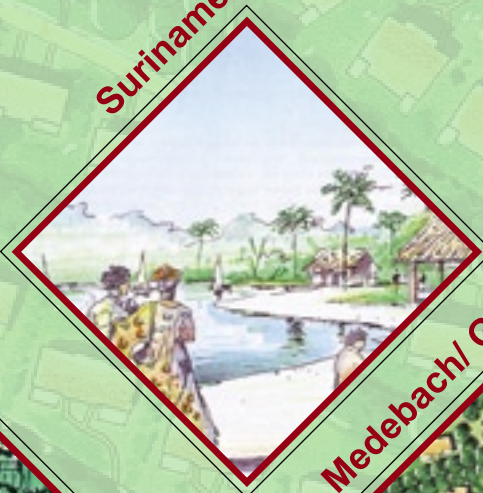

Malaga/ Spain



Medebach/ Germany



**PROFILE**

Rockanje/ The Netherlands



2007-3

**BURO**

Landscape in recreation and tourism

**recreational**

**EUROLANDSCAPE**

Landscape Architects & Urban Planners

Moerdijkstraat 23 2751 BE Moerkapelle The Netherlands +31 (0)79-5931819



**HOLLANDSCHAP**  
Adviesburo voor Sted- en Landschapinrichting

ing. P. van Loon  
President  
landscape architect BNT

Moerdijkstraat 23  
2751 BE Moerkapelle  
The Netherlands  
tel. +31 79-5931819  
fax. +31 79-5932498  
e-mail: mail@hollandschap.nl  
www.hollandschap.nl

**EUROLANDSCAPE**  
Landscape Architects & Urban Planners

Moerdijkstraat 23  
2751 BE Moerkapelle  
The Netherlands  
tel. +31 79-5931819  
fax. +31 79-5932498  
e-mail: mail@eurolandscape.com  
www.eurolandscape.com  
www.eurolandscape.eu

Bron: Historische Kaart Topografische Dienst  
Verkend in 1850 en 1851



Den Haag

Gouda

Rotterdam

Moerkapelle , a village in the Green Heart.  
Above Rotterdam, near the river Rotte.

## LANDSCAPE ARCHITECTS

Recreational areas, resorts, **landscape** exhibitions and **flower** shows and the role of the landscape architect.

Almost 25 years **EUROLANDSCAPE** has been involved in the development of **pleasure projects**. Although as landscape architects we focus on the masterplanning and the landscape aspects, many other disciplines are part of the design of such projects. Because of our **international** experience we know how to deal with the **different cultures** and behaviour of the public. **The public** / visitors play the most important role in these projects as **their behaviour, enjoyment and satisfaction** is the reason for them to come back and give a positive mouth-to-mouth advertisement.

In the presentation which is in front of you, you will find our role as independant, **multidisciplinary** design team. Our job is to investigate and analyse **the site** together with the client and his consultants to generate the new plans, where again the atmosphere and activities are key components. The aim of our presentation is to give you an **impression** of the different projects we have been involved in. In the brochure you'll find an extensive list of all the projects that have been build or are under development. Our **plans** are developed in such a way that every time we try to maximize and optimize **the goals of the client**. Every new project is a challenge and we like to approach it in a realistic way. This is where we think our strength is.

Pieter van Loon, Landscape Architect  
President **EUROLANDSCAPE**

### LANDSCAPING RECREATIONAL AREAS AND GROUNDS

Bonaire, Port Bonaire – Netherlands Antilles

**Breukelen, recreational area de Mijnden**

Baarn, Treetophotel

Brive, design plan – France

**Curaçao, Rif St. Marie – Netherlands Antilles**

**Curaçao, Queens Beach vdValk - Netherlands Antilles**

**Dirkshorn, development of wellness resort**

Domburg, Park Buitenhof

Hellevoetsluis, Den Bonsen Hoek

Lisse, Keukenhof, New main entrance, parking and circulation

**Medebach, Cocopark Gran Dorado - Germany**

**Middelharnis, project Nieuw Zeeland**

Maarn Camping Laag Kanje

NoordBeveland, de Banjaard

**Nantes, masterplan Chateau d'Olonne - France**

**Paramaribo - Surinam**

PortDienville, masterplan - France

**Phuket, Villa Santi - Thailand**

Scharendijk, Park de Bout

Standdaarbuiten, development plan for recreational area

Stromberg, Gran Dorado - Germany

Woudsend De Rakker recreation

Well, recreational houses Leukermeer

Wörgl – Austria

Zandvoort, Gran Dorado area

### DEVELOPMENT OF RECREATIONAL AREAS

Battenoord Haven recreational development

Battenoord vision on recreation and landscaping

Doetinchem, recreational area Koekendaal

Den Bommel, Recreation and natural area

Oostvoorne, Lake Oostvoorne

Rockanje and the Duin

Rockanje, vision on recreation and tourism

Rockanje, elaboration of the Duinboulevard

### LIVING AND RECREATION

Binnenmaas, Golf park

Binnenmaas, vision on recreational area

**Curaçao, Rif St. Marie - Netherlands Antilles**

**Dordrecht, Golf, living and conference**

Hellevoetsluis, Heliushaven

**Melisant, recreational resort, golf course and housing**

**Numansdorp, Golf course**

**Schiphol, Golf course**

Zevenhuizen resort The Koorrmolen

### EXHIBITIONS AND BOTANICAL GARDENS

Amsterdam Floriade 1982

**Columbus, Ohio, Gardens and Conservatory - USA**

**Boston, Elm Bank - USA**

**Boston, Flowershows - USA**

**Malaga, El Retiro - Spain**

**New Castle, Gateshead - UK**

**Redding, Turtlebay - USA**

Rotterdam, Blijdorp Zoo

Singapore, Marina South

### PLAYGROUNDS

**Amersfoort, dome shape over playground**

Amersfoort, playground De Kas

Apeldoorn, Apenheul

Ath, play dome

Bennebroek, Linnaeushof paviljon and playground

Callantsoog, Dome Prima Bella

Falkirk Callenderpark - UK

Wembley Vale Farm - UK

Oss, dome shaped roof over swimming pool

'sGravenzande, vision and maintenance plan for playgrounds



### RECREATIONAL PARKS

Alphen, redesigning Avifauna Park

Koudem, recreational park De Kuilart

Port Zélande Resort

Wanrooy, de Bergen

Zevenhuizen recreational design plan

## PROJECTS

AMSTERDAM	Gaasperplaspark Floriade '82	6
AMSTERDAM	Golfcourse Schiphol International Airport	8
COLUMBUS (U.S.A.)	Franklin Park Conservatory	10
DORDRECHT	Residential golf courses	12
ELM BANK (U.S.A.)	Massachusetts Horticultural Society	14
GATESHEAD (U.K.)	National Garden Festival	16
LISSE	Keukenhof	18
LOOSDRECHT	Recreational and pleasure park Mijnden	20
MALAGA (SPAIN)	El Retiro	22
MEDEBACH (DUITSLAND)	Cocoparc Grandorado	24
MIDDELHARNIS	Nieuw Zeeland	26
PARADISTRICHT (SURINAME)	Para district Paramaribo	28
PHUKET (THAILAND)	Villa Santi	30
REDDING (U.S.A.)	Turtle Bay	32
RHOON	Sportpark Albrandswaard	34
ROCKANJE	Dune area Rockanje	36
SINGAPORE	Marina South Park	38
STANDDAARBUITEN	Recreational area Markdal	40
St. WILLIBRORDUS (CURAÇAO)	Nature Resort Rif St. Marie	42
ZOO AMERSFOORT	De Koepel	44
HOW TO REACH US	Office	46

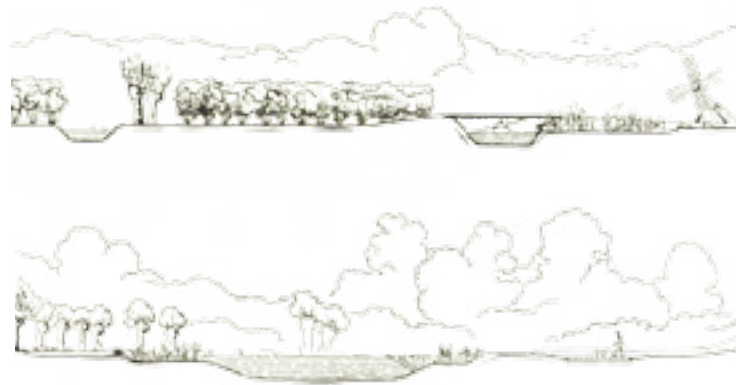

Every 10 years an international garden festival is organised in The Netherlands. In 1982 this festival, called Floriade, was held in the Regional Park Gaasperplas in Amsterdam. Approximately 4 years earlier the work on the festival site started. Pieter van Loon worked at that time as substitute of the principle landscape architect and he was coordinator of the landscape design team. In this period the site of 55 ha was transformed from polder into an exhibition park. Over 3,5 million people visited the Floriade in 1982.









# GOLFCOURSE SCHIPHOL INTERNATIONAL AIRPORT



# COLUMBUS (U.S.A.)



In 1992 Franklin Park, Columbus, the largest city with the name Columbus in the U.S.A., hosted the Ameriflora. This international floral and garden festival has been organised to celebrate the 500 years of discovery of America by Columbus. The exhibition was held in an existing city park. A masterplan has been generated and in this masterplan there was an enormous, 9.000 m<sup>2</sup>, renewed conservatory. The aim of the conservatory was to create a tourist recreational facility (all weather) where the educational aspects of the botany were very important. At the same time the conservatory had to host many other events that helped generate their incomes. **The exhibition has been designed to have at least 11 different climates, varying from cool to hot / tropical, which in the location of Columbus Ohio creates a unique atmosphere.**





FRANKLIN PARK CONSERVATORY  
COLUMBUS OHIO . U.S.A.



EUROLANDSCAPE has been involved in a few residential golfcourses and one of them is on the south site of Dordrecht (the Netherlands). The aim is to create a landscape setting for the golfcourse and to create a nice housing environment (top segment) for new town houses and estates. We were involved in the development of different concepts. At last was chosen for a 92 ha site to create a natural environment of which part is open to the public (18 ha) while the rest was being used for the golfplayers and residents.





In consultation with the Massachusetts Hortical Society EUROLANDSCAPE produced a masterplan for their “botanical” garden. The old estate has been rejuvenated / renovated and different garden zones were created. Each zone has its own identity in which gardens could be, and have been, designed to tell the botanical message to the public. At the same time the site of Elm Bank is attractive for garden lovers.



# GATESHEAD (U.K.)

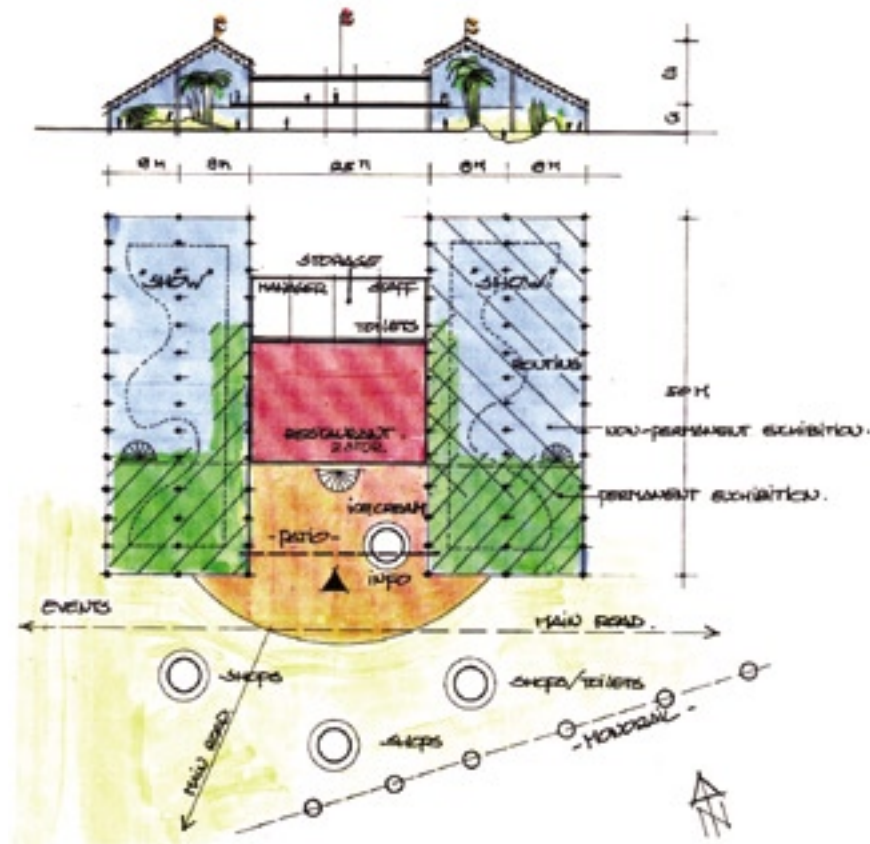

In 1990 the National Garden Festival was organised in Gateshead (north east England). On this 90 ha large site different aspects of horticulture, landscaping and recreation were integrated. EUROLANDSCAPE produced the final masterplan for the show and the team developed all concepts and most of the designs to fit with this festival lay-out. A few million people have been visiting the site.

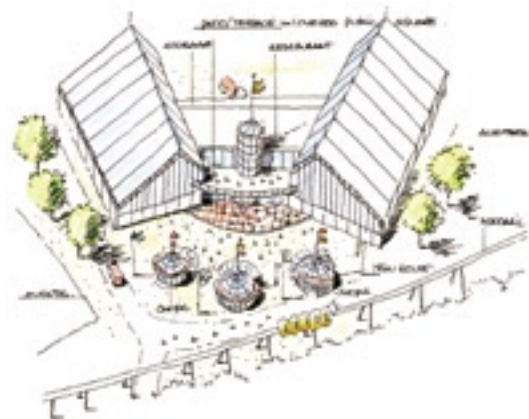



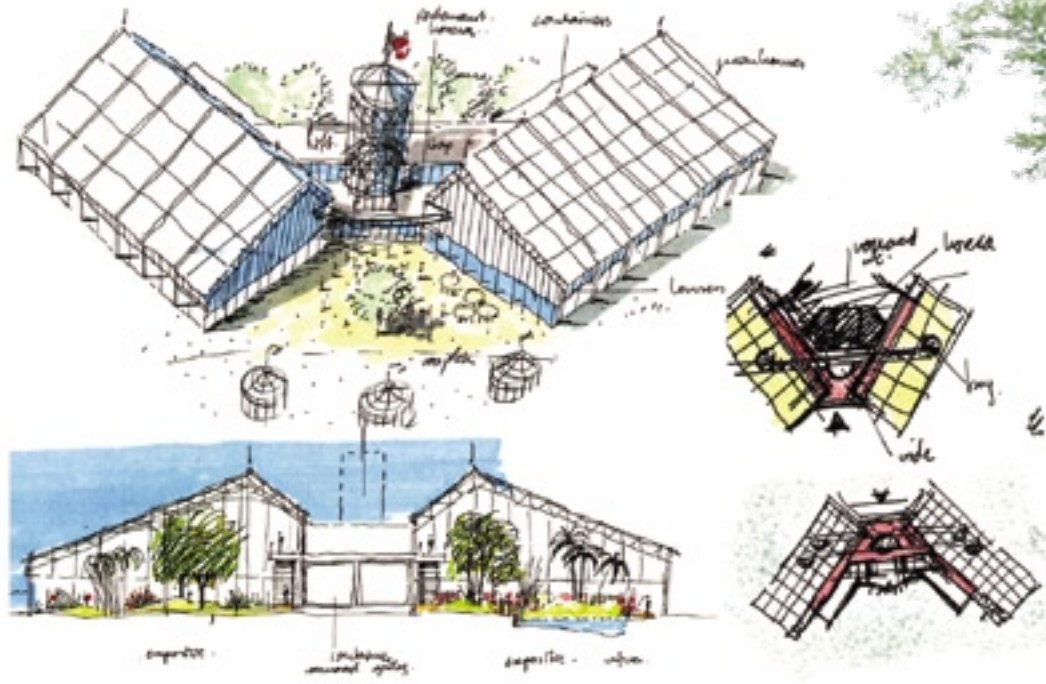

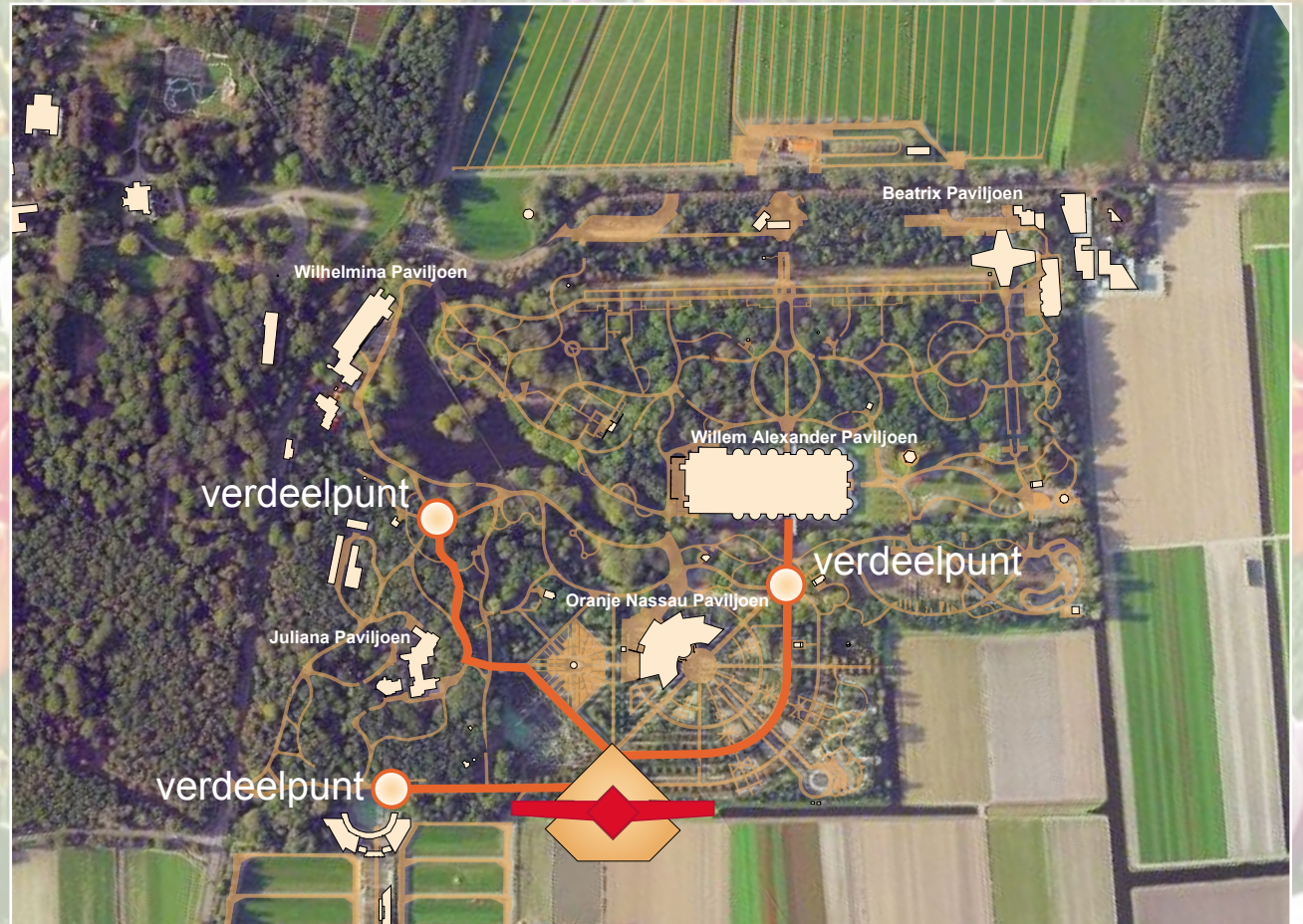

The international; wellknown floral exhibition Keukenhof in Lisse wanted to adjust the circulation of the exhibition site, the parking areas and the entrances. After an analysis of the present problems a plan was designed to relocate the parking area and the main entrance. Both changes will have a positive influence on the circulation of the site. Keukenhof receives every year approx. 800.000 visitors in only two month time.



structures

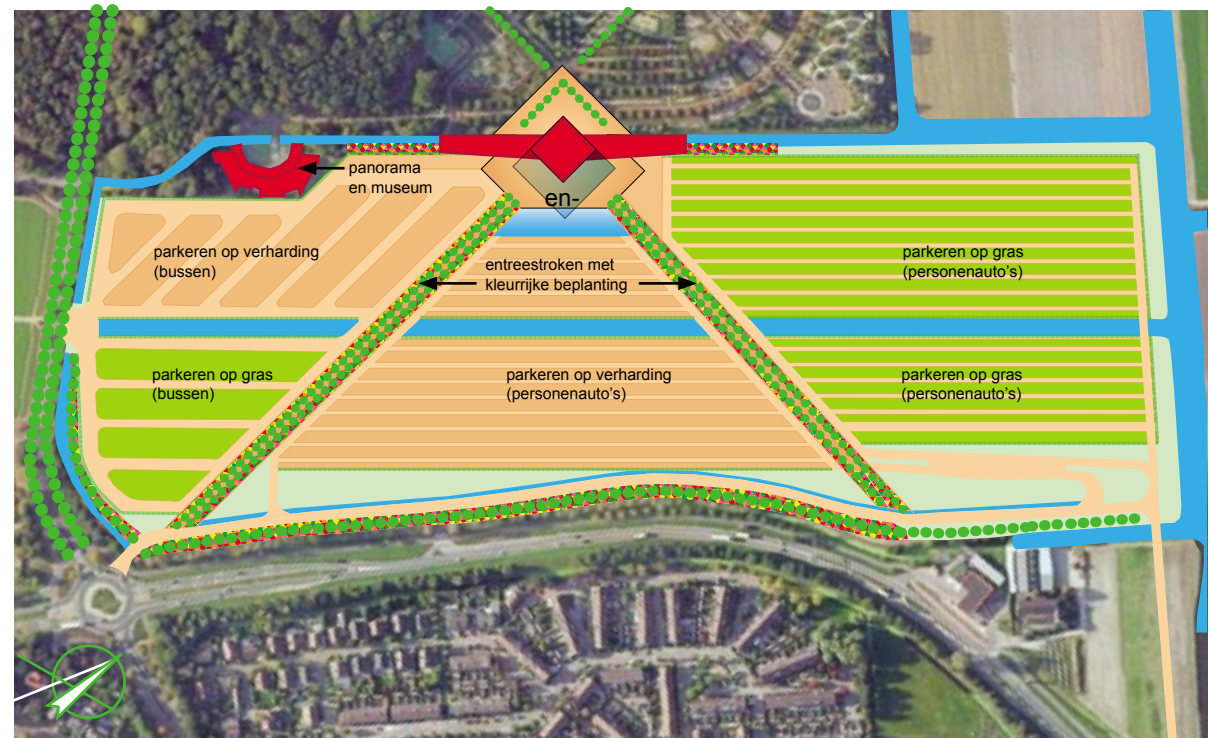
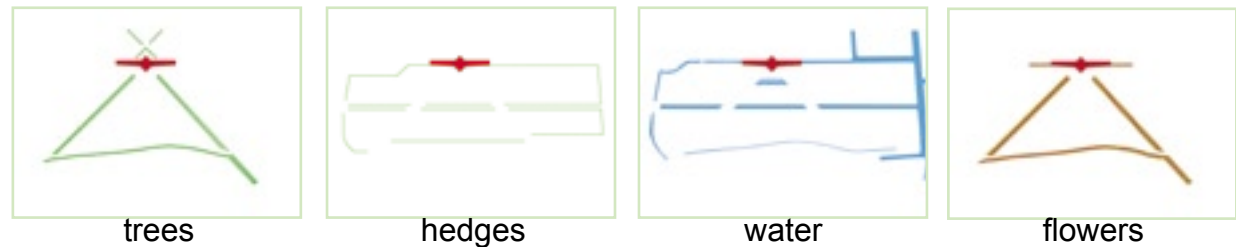



Kwaliteitskaart Wegen



Ruimtelijke kwaliteitskaart



Kwaliteitskaart Groen



Inventarisatiekaart Groen



Inventarisatiekaart Wegen



Inventarisatiekaart Water

Recreational and pleasure park Recreatiecentrum Mijnden has asked HOLLANDSCHAP / EUROLANDSCAPE to make a new masterplan for the potential use of this existing recreational facility. By re-arranging the site and introducing more water, we now have a more attractive and natural setting for the visitors and almost-permanent-residents that like to spend their summer in this attractive area, close to the major waterbodies in the Netherlands.





Park El Retiro is a bird park based on the natural habitats of birds from different parts of the world. This old palace became a recreational restaurant and the adjacent old botanical garden has been renovated. The extension of the site is developed with different large aviaries to educate people on behaviour and species of the various birds. Areas like Indonesia, Africa, Europe and Australia are part of the zoning concept. The interesting contours of the site create (landscape) surprises that attract the visitors.



# MEDEBACH (DUITSLAND)

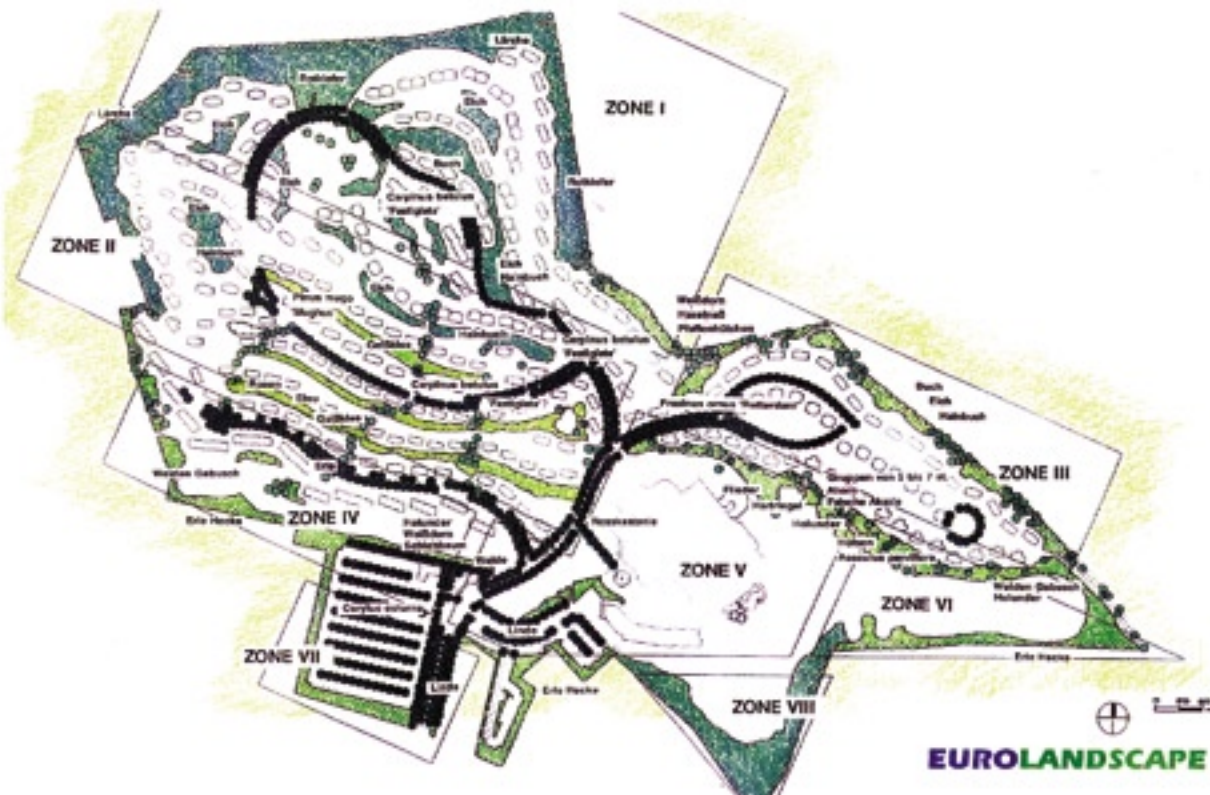

Medebach is one of the so-called Center Parcs holiday parks. The masterplan has been created by EUROLANDSCAPE and the principle architect Zeelenberg. The existing vegetation and the contours of the site were the main criteria to locate about 500 second homes and the central facility that includes swimming, major leisure facilities, restaurants, and hotels. By planting many trees a new wooded character has been established while the different zones will have their own natural character.









A recreational project with about 200 houses close to the main waterbodies of the Haringvliet and the yacht-club is located there. The project has an unique character just behind the dikes in the polderland. Phase 1 has been constructed about 7 years ago and is now full grown and very much appreciated by the inhabitants.







The interesting Para district in Suriname consists of an old mining site. This site needed landscaping and environmental control after the mining activities have been stopped. The existing waterbody and remains of the tropical forest form the base for the new concept. The area will be redeveloped with the theme of nature (eco tourism) and has facilities for day activities and long stay activities. A golf course with some prominent villas will be included. It is an interesting project to generate new jobs, new goals for tourism and at the same time restore and redevelop new nature habitats.

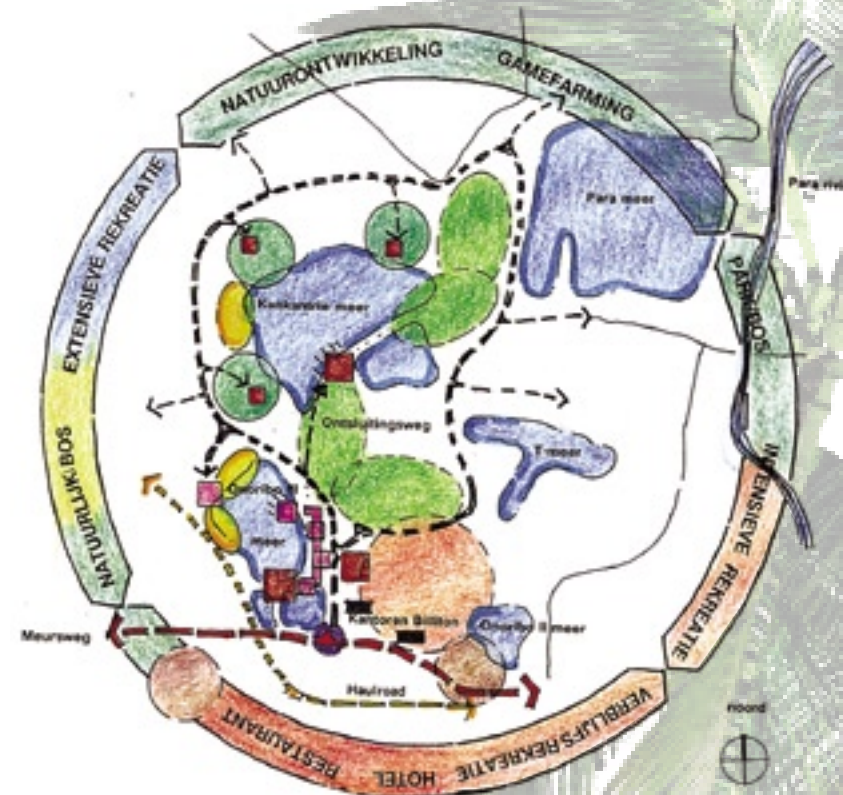

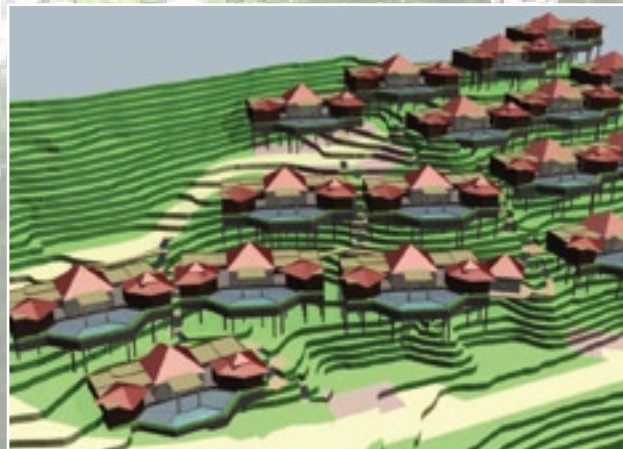
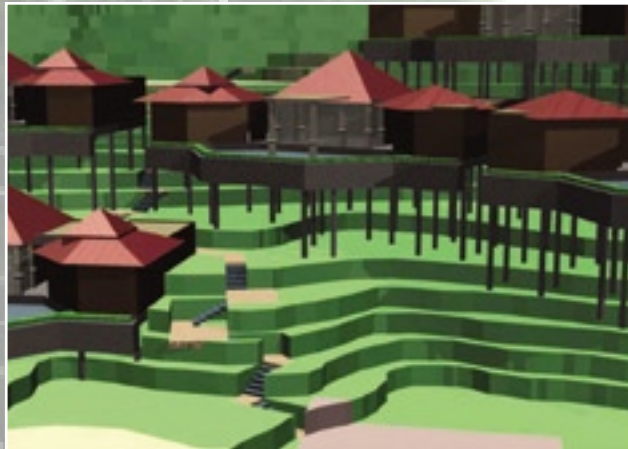

Near the wellknown town of Patong Phuket EUROLANDSCAPE has been involved in the masterplaning and detailed design of a hundred unit tropical resort. The project consits of spa villas, condominiums, studios, residential permanent housing and a small hotel.

On the beach side there will be a restaurant. This hilly site has almost been without any vegetation and the new plantings will give it a lush tropical character.







An existing themepark at the shore of the Sacramental River has asked EUROLANDSCAPE to generate a new masterplan and review the existing exhibits. After the new pedestrian bridge has been built across the Sacramental River the project received an enormous growth in visitors. The so-called Sundial Bridge is so attractive that return visits are enormous, but also visitors from all over the USA are coming to explore this major themepark which has the highlights with botanical gardens, arboretum and a nature museum. Circulation and extending the exhibits were the main components of the masterplan.

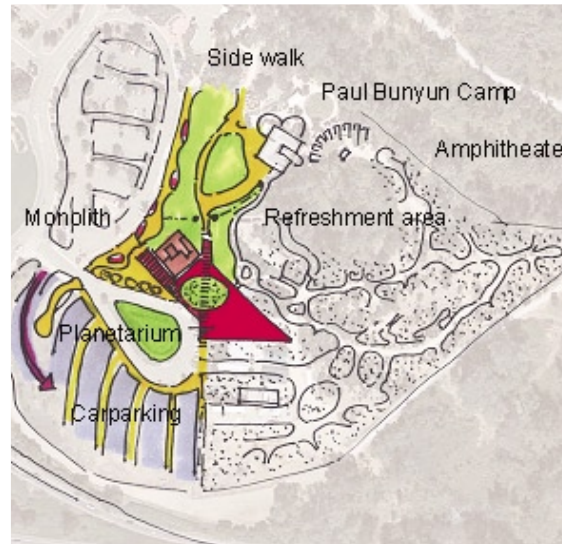



The municipality of Rhoo (near Rotterdam) wanted to re-locate and expand their sportsfields near a housingarea. The objective was to integrate the new sportsarea in the environment, and making it a part of the already existing ecological zone.





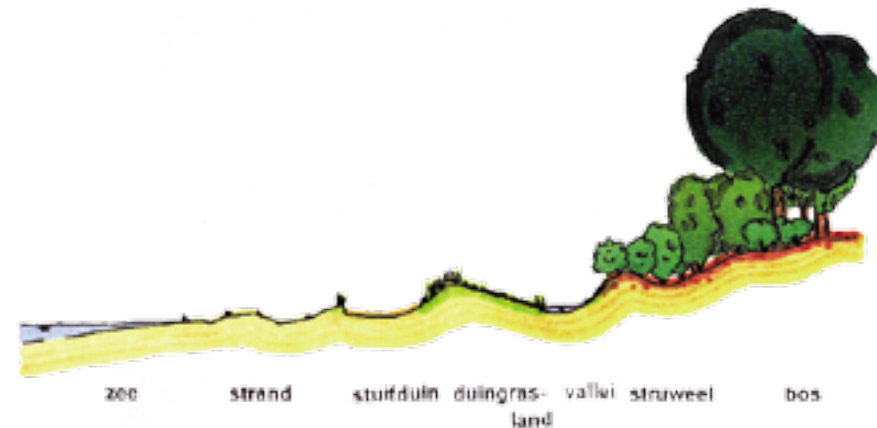

HOLLANDSCHAP / EUROLANDSCAPE was asked to further develop the plans for a “nature” esplanade and the dune area near Rockanje, a popular seaside place in the Randstad area of the Netherlands. The report consisted of two parts. The first part included an analysis of the concerning area and a an outline of the concepts that can be developed.

The other part included a few models for the design of the dune area and the center of Rockanje that served for discussion.





In 1989 a 58 ha site was used for the first garden festival that was being organised in the Asian region. In a short time the area was being transformed into a beautiful exhibition park with views on the skyline of the financial and commercial district of Singapore and the impressive Benjamin Sheares Bridges of the East Coast Parkway. After the festival approx. 25 ha of the festival site was set up as a permanent park: the Marina South Park.

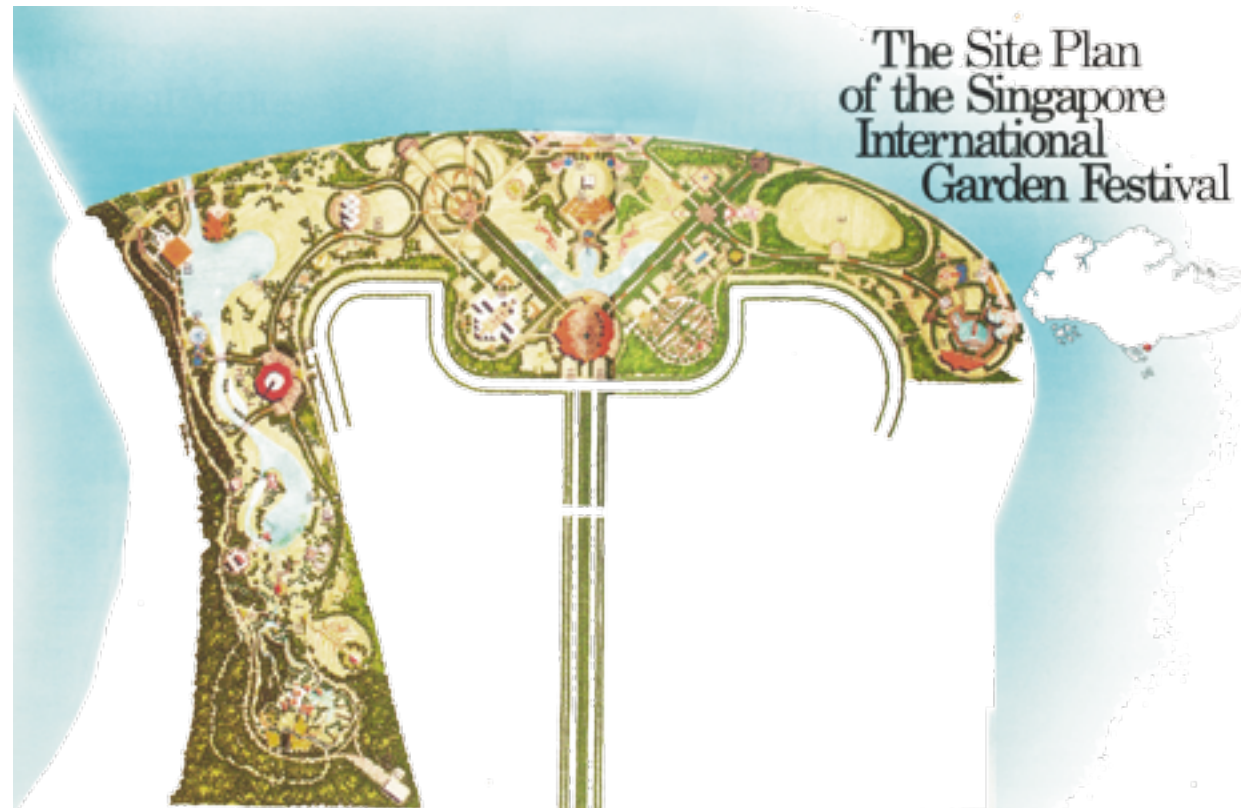



For the Markdal site in Standdaarbuiten (the Netherlands) HOLLANDSCHAP / EUROLANDSCAPE developed a plan to convert the temporary camping site into a permanent camping site with more extended recreational facilities. In this new concept also 95 second homes were included of which a part is floating in the small river next to the site.









The site is situated on Curaçao, in the neighbourhood of the small village St. Willebrordus. The masterplan for Nature Resort Rif St. Marie was based on the concept of structure and theme. Structure: Both urban planning as well as landscaping were equally developed taking into account that the present vegetation had to be preserved. Theme: The masterplan should consist of elements that were characteristic for the island. This meant that not only the theme nature was developed, but also the themes plantation/country estate and the (Caribbean) seashore.



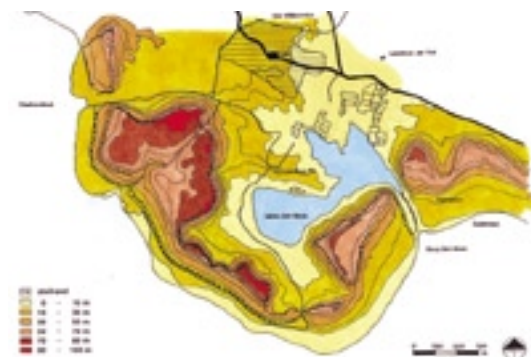
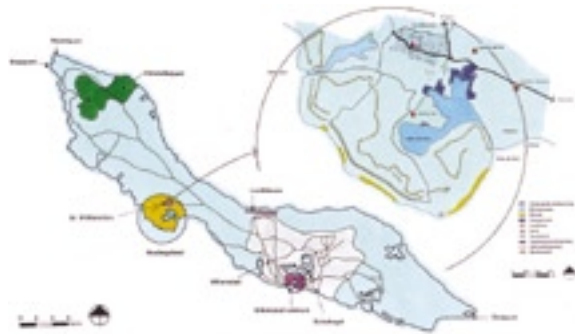



In July 1991 an unique hanging playground was opened in the Zoo of Amersfoort. This playground consisted of slides, jungle bridges and climbing frames that were attached to a wooden dome construction; height 8 meters / cross section 40 meters. In the period before the play dome was realized an analysis was made of the environment (vegetation, soil etc) and the visual aspects (view from and towards the dome). Thanks to the open construction of the dome it was possible to integrate several existing, valuable trees.

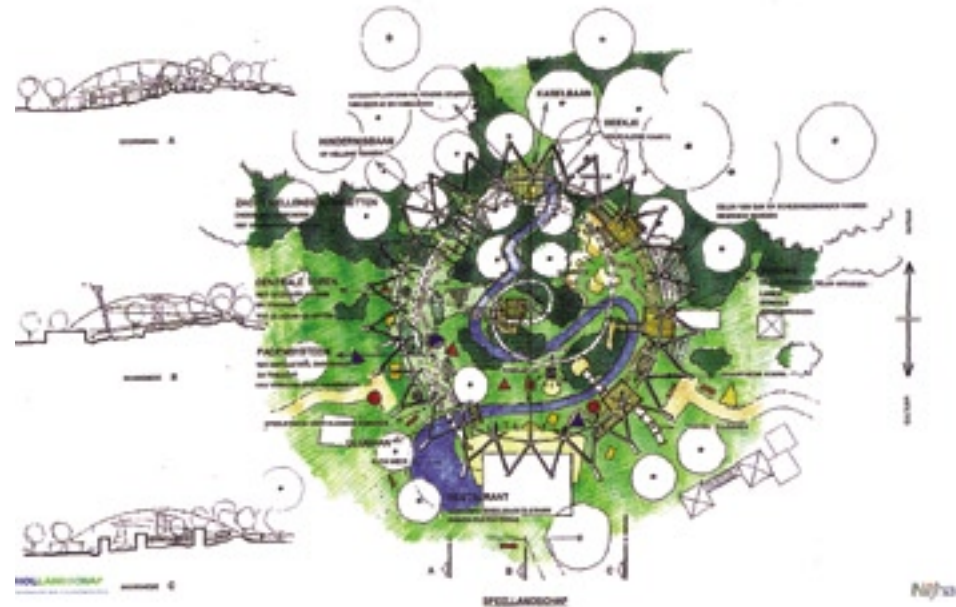



## A 12 Den Haag - Utrecht

- 1 exit "Bleiswijk"
- 2 exit "Zevenhuizen / Moerkapelle" \*\*
- 3 exit Wadinxveen/Moerkapelle

## A 20 Utrecht – Rotterdam

- 4 exit "Moordrecht"
- 5 exit "Nieuwerkerk a/d IJssel"

## A 4 Amsterdam – Den Haag

- exit "Zoeterwoude" – "Leiden" – "Utrecht" – N 11
- exit in the direction of "Hazerswoude"
- 6 direction "Benthuizen" – "Bleiswijk" – N 209
- 7 exit to "Kruisweg"
- 8 direction "Moerkapelle"

\* The fastest connections while there are no traffic jams.

## PUBLIC TRANSPORTATION

The next bus lines (Connexion) are stopping in Moerkapelle:

Bus line 177 : Gouda NS – Zoetermeer CW (via Wadinxveen, Zevenhuizen, Moerkapelle)

Interliner 382: Boskoop – Den Haag Centraal (via Wadinxveen, Moerkapelle, Zoetermeer, Voorburg)

Interliner 383: Capelle a/d IJssel – Den Haag Centraal (via Nieuwerkerk a/d IJssel, Nesselande, Zevenhuizen, Moerkapelle, Zoetermeer, Voorburg)

**HOLLANDSCHAP™**  
 Adviesburo voor Stads- en Landschapsinrichting

ing. P. van Loon  
 President  
 landscape architect BNT

Moerdijkstraat 23  
 2751 BE Moerkapelle  
 The Netherlands  
 tel. +31 79-5931819  
 fax. +31 79-5932498  
 e-mail: mail@hollandschap.nl  
 www.hollandschap.nl

**EUROLANDSCAPE™**  
 Landscape Architects & Urban Planners

Moerdijkstraat 23  
 2751 BE Moerkapelle  
 The Netherlands  
 tel. +31 79-5931819  
 fax. +31 79-5932498  
 e-mail: mail@eurolandscape.com  
 www.eurolandscape.com  
 www.eurolandscape.eu

